

MAIN SERVICE PANEL SCHEDULE

SWITCH No.	SERVICES	WATTS	SIZE	FUSE	USE
1	A-1	19,000	60A	50A	
2	B-1	19,000	60A	60A	
3	C-1	8,000	60A	60A	
4	A-2	6,000	60A	50A	
5	B-2	11,500	60A	60A	
6	C-3	8,000	60A	60A	
7	CONCRETE	1,000	60A	35A	
8	FEED ROOMS	3,000	60A	35A	
		TOTAL LOAD	53 KW		

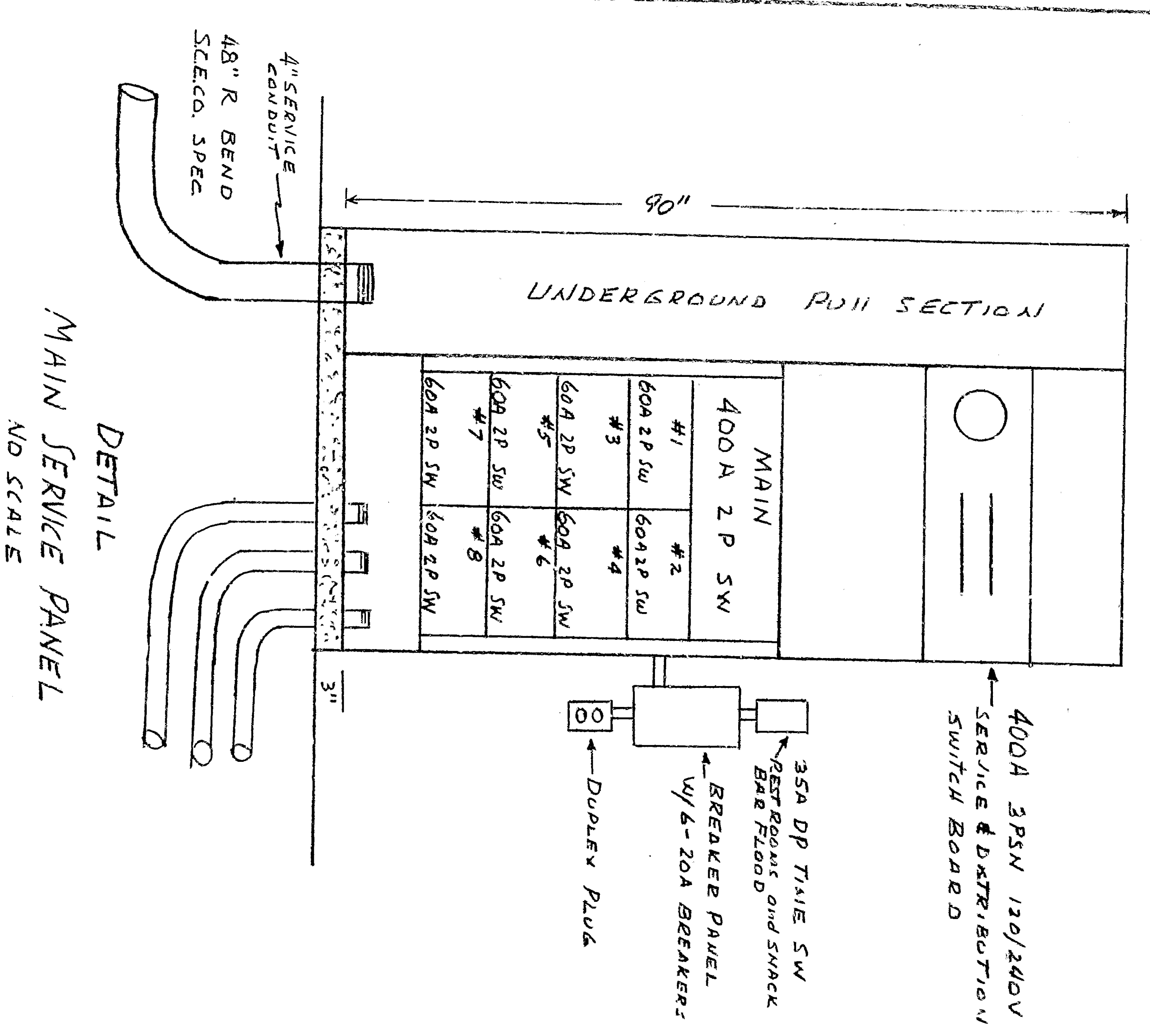

CONDUCTOR RUN SCHEDULE

▽	3#4 (CIR 1 TO PANEL 1), 3#4 (CIR 2 TO PANEL 2), 3#4 (CIR 3 TO PANEL 3)	2" CONDUIT
▽	3#4 (CIR 1 TO PANEL 1), 3#4 (CIR 2 TO PANEL 2), 3#4 (CIR 3 TO PANEL 3)	2" CONDUIT
▽	3#4 (CIR 3 TO PANEL 3)	1 1/2" CONDUIT
▽	3#4 (CIR 3 TO PANEL 3)	1" CONDUIT
▽	3#4 (CIR 3 TO PANEL 3)	1 1/2" CONDUIT
▽	3#4 (CIR 3 TO PANEL 3)	2" CONDUIT
▽	3#4 (CIR 3 TO PANEL 3)	1 1/2" CONDUIT
▽	3#4 (CIR 3 TO PANEL 3)	2" CONDUIT
▽	3#4 (CIR 3 TO PANEL 3)	1 1/2" CONDUIT
▽	3#4 (CIR 3 TO PANEL 3)	1" CONDUIT
▽	3#4 (CIR 3 TO PANEL 3)	1" CONDUIT
▽	3#4 (CIR 3 TO PANEL 3)	2" CONDUIT

4" UNDERGROUND SERVICE CONDUIT ACCORDING TO S.C. CALIF. EDISON STANDARDS. CONTRACTOR SHALL VERIFY SERVICE LOCATION AND REQUIREMENTS AND PAY ALL COSTS INCLUDING EXCESS FOOTING, CONDUIT, AND LABOR. GIVEN BY EDISON CO. FOR READING ELECTRICAL SERVICE TO THE JOB WITHOUT ABANDONAL COST TO THE CITY.

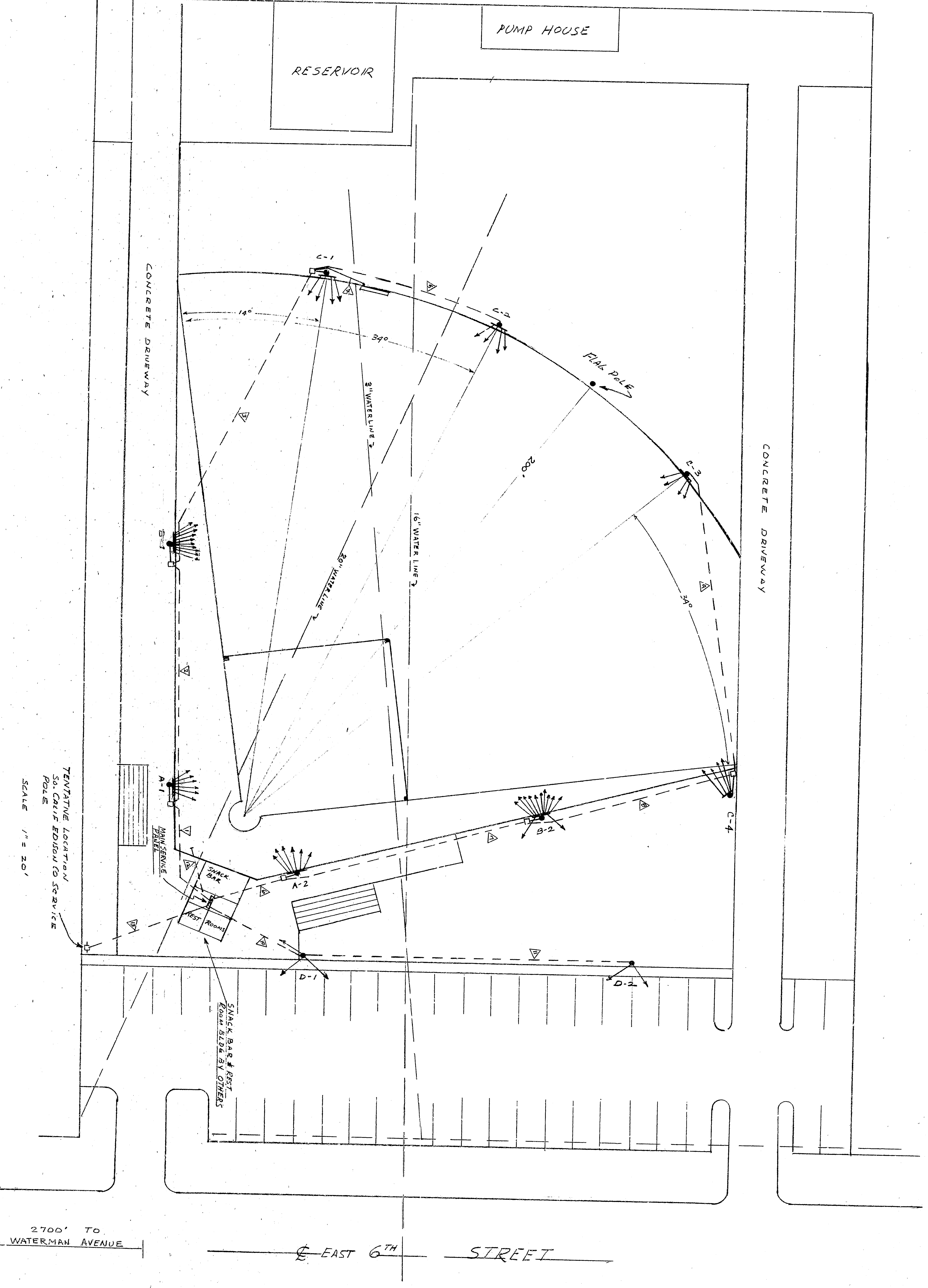

APPROVED: *[Signature]* 1987
 CITY ENGINEER
 REGISTERED CIVIL ENGINEER No. 11485
 DRAWING NO. DRAWN BY: *[Signature]*
 CHECKED BY: *[Signature]*
 3998
 REGISTERED CIVIL ENGINEER No. 11485
 BALL FIELD LIGHTING SYSTEM
 GIRLS SOFT BALL
 APTIL BALL PARK
 EAST 517TH STREET
 SAN BERNARDINO, CALIFORNIA